

PISTHV

For High Voltages up to 400V DC

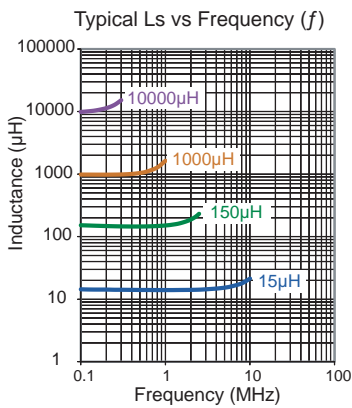
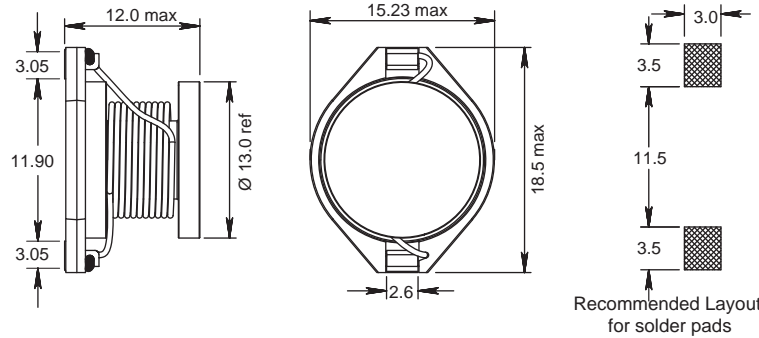

| Part No | Inductance | f_L (kHz) | Tol \pm (%) | SRF min (MHz) | DCR max (Ω) | Rated DC Current (A) | |
|----------------|---------------------|----------------|------------------|---------------------|----------------------------|----------------------|-----------------------------------|
| | L (μH) | | | | | I_{sat} | $I_{\Delta T = 40^\circ\text{C}}$ |
| PISTHV-150M-04 | 15 | 100kHz, 0.1V | 20 | 11.35 | 0.034 | 7.85 | 4.90 |
| PISTHV-820M-04 | 82 | 100kHz, 0.1V | 20 | 4.09 | 0.104 | 3.95 | 2.50 |
| PISTHV-151M-04 | 150 | 100kHz, 0.1V | 20 | 4.00 | 0.200 | 2.87 | 1.90 |
| PISTHV-301M-04 | 300 | 100kHz, 0.1V | 20 | 2.00 | 0.390 | 2.10 | 1.20 |
| PISTHV-331M-04 | 330 | 100kHz, 0.1V | 20 | 2.00 | 0.450 | 1.85 | 1.20 |
| PISTHV-471M-04 | 470 | 100kHz, 0.1V | 20 | 1.65 | 0.650 | 1.40 | 0.90 |
| PISTHV-681M-04 | 680 | 100kHz, 0.1V | 20 | 1.35 | 0.770 | 1.40 | 0.80 |
| PISTHV-102M-04 | 1000 | 100kHz, 0.1V | 20 | 1.20 | 1.200 | 1.17 | 0.65 |
| PISTHV-472M-04 | 4700 | 100kHz, 0.1V | 20 | 0.55 | 5.200 | 0.65 | 0.30 |
| PISTHV-602M-04 | 6000 | 100kHz, 0.1V | 20 | 0.48 | 6.700 | 0.60 | 0.26 |
| PISTHV-802M-04 | 8000 | 100kHz, 0.1V | 20 | 0.41 | 8.640 | 0.56 | 0.24 |
| PISTHV-103M-04 | 10000 | 100kHz, 0.1V | 20 | 0.40 | 10.50 | 0.39 | 0.21 |

Core Material: Ferrite

Revision date: 04 Mar 2022

Base Material: Plastic

SPQ: Taped / Reel 200 [-04]

Remarks: I_{sat} & $I_{\Delta T}$ - see description in Inductors Technical Data.

Terminal clip with lead-free tinned surface for SMT-Reflow soldering.

